

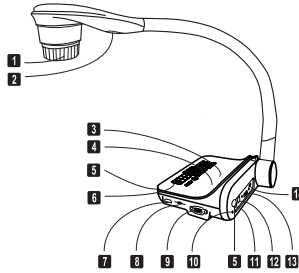

Lancement rapide de votre visualiseur *SPE-VI-401*

Quick start guide



Noms des composants - Component names

- | | |
|---|---------------------------------------|
| 1. Camera - Camera | 8. Carte SD - SD card slot |
| 2. Lumière LED - LED lamp | 9. Sortie VGA - VGA output port |
| 3. Haut-parleur - Speaker | 10. Fente antivol - Antitheft slot |
| 4. Microphone - Microphone | 11. Alimentation - DC 5V Power socket |
| 5. Récepteur du signal de la télécommande
Remote control signal receiver | 12. Port USB - USB port |
| 6. Panneau de contrôle - Control panel | 13. Sortie VGA - VGA output port |
| 7. Entrée HDMI - HDMI input port | 14. Sortie HDMI - HDMI output port |

Panneau de contrôle - Control Panel

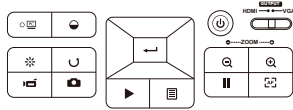

- ⏻ Marche/Arrêt - Power on/off
- ☀️ Allumer / Eteindre / Régler l'intensité de la lumière LED - Turn on/off the LED lamp and adjust the brightness of the LED lamp.
- ↔️ Inverser l'image - Flip image
- 📷 Mode Photo / Film - Capture still image/Record video clip
- ⏸️ Figurer l'image - Freeze current image
- 🔍 Zoomer - Zoom in
- 📐 Mise au point automatique - Autofocus
- 🔍 Dézoomer - Zoom out
- ▶️ Mode lecture pour afficher les photos et vidéos enregistrées - Playback Mode to display recorded images and videos
- OUTPUT Permuter entre les sorties VGA/HDMI - Switch between HDMI/VGA outputs

Avec un ordinateur via USB - With a computer via USB

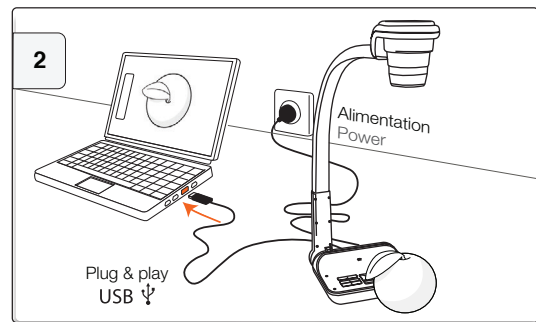
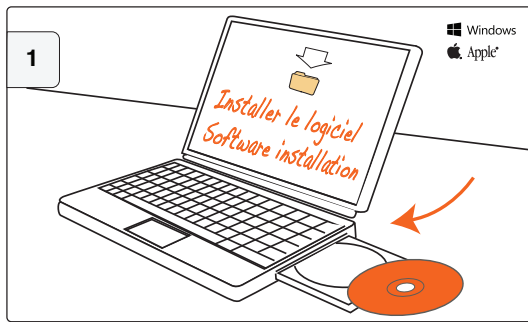

Sans ordinateur, directement sur un écran - Without a computer, direct connection to screen

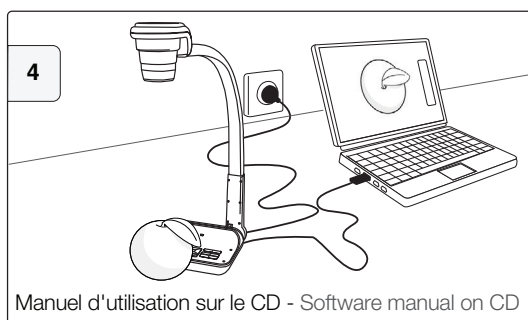
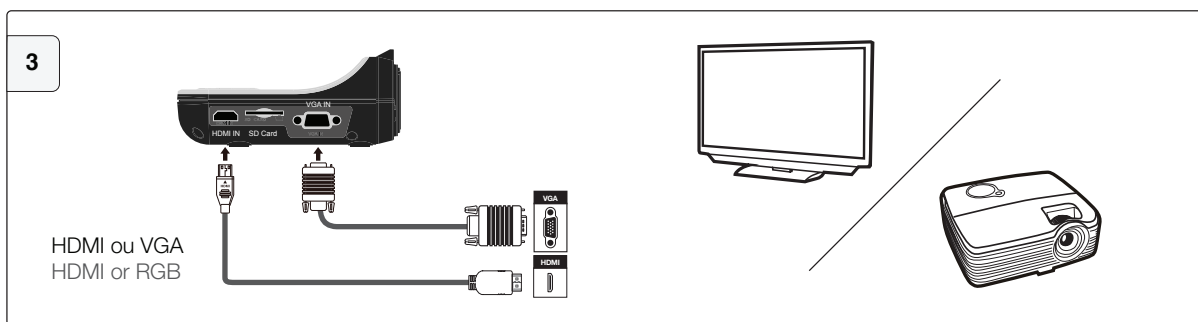

5

Support :
www.speechi.net/support/spe-vi-401

Email :
support@speechi.net