

System Requirements

To ensure normal operation of the touch function, follow below requirement to check your system condition.

| System requirement | |
|--------------------|---|
| Operating syste | Microsoft Windows XP (SP3)/ Windows 7(32bit/64bit)/ Windows 8/ Windows 8.1(. NET Framework 4.0 must be installed) |
| | Mac OS X(10.7~10.10) |
| CPU | Intel® Core™ i3 or above |
| Memory | 2GB above |

Accessories Introduction

- Function Key on the "Light Pen".

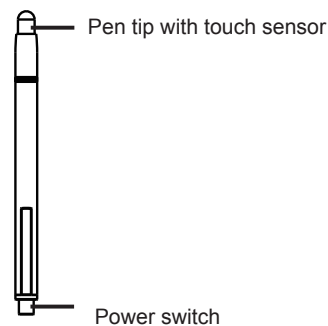

How to extend the light pen

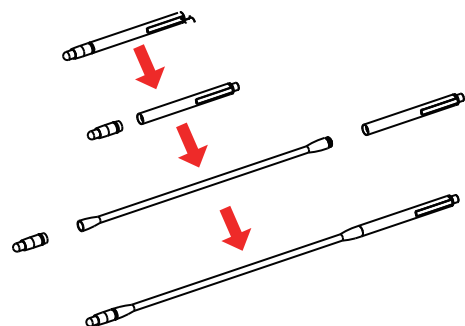

Step 1: Remove the light pen head from the light pen body.

Step 2: Assemble the extension rod with the light pen.

Install TouchCalibration

1. Windows

- Step 1. Insert the "Owner's Manual" CD-ROM into the CD drive.
- Step 2. Open the "LightPen Software for Windows" folder in the CD-ROM.
- Step 3. Double click " TouchCalibration.exe" by mouse. And then the window will appear as below

Step 4. Click" SPDriver" .And then "Setup Wizard" window will appear as below.Click "Next" to install.

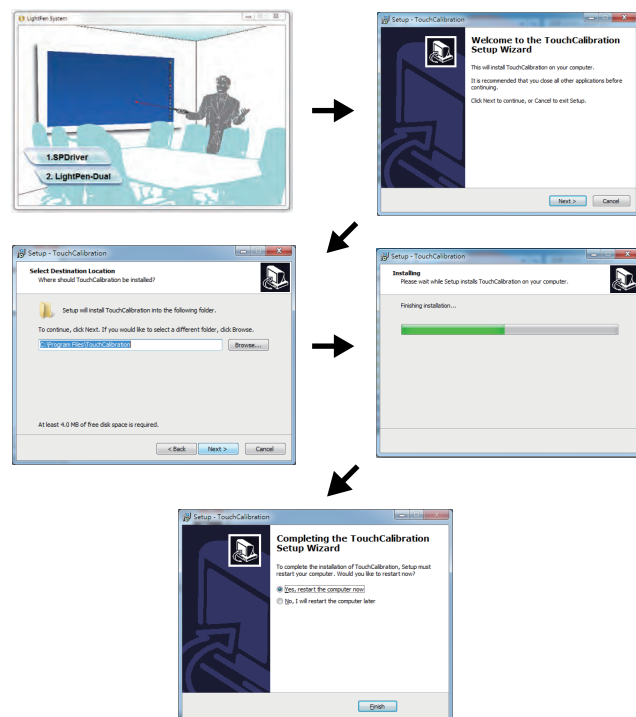

2. Mac

- Step 1. Insert the "Owner's Manual" CD-ROM into the CD drive.
- Step 2. Open the "LightPen Software for Mac" folder in the CD-ROM and copy"mac.zip" to the disk.
- Step 3. Double click and move SPDriver ICON to computer screen and execute it.

indicator

Utility icon indicator on the task bar as below:

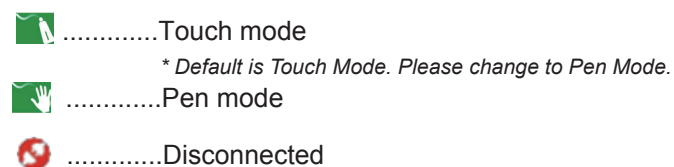

Operation Mode

Default is Touch Mode. Please Click "Operation Mode" from "Touch Mode" to "Pen Mode". Windows 7 and Windows 8 operating system support multi-point touch control.

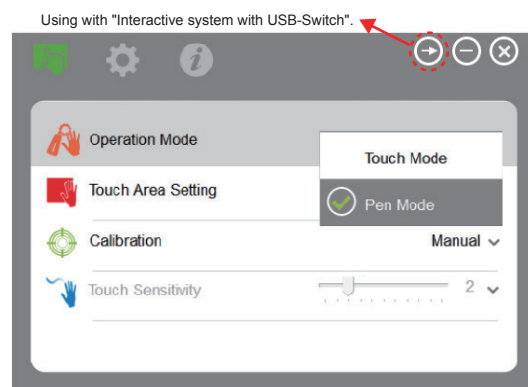

*Only single-point touch is available for Windows XP and Mac OS X.

Touch Area Setting

1. Auto Touch Area Setting

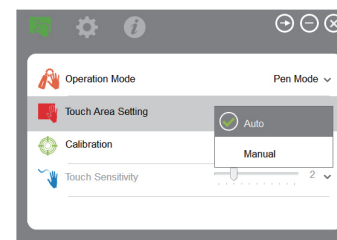

Note:

- Quit all software application
 - Reduce ambient light
 - Do not obstruct or shake lens during Touch Area Setting
 - Check if projection image is clear. If not, adjust focus to sharpen the image
- If fail message pops up, switch to Manual Touch Area Setting.

2. Manual Touch Area Setting

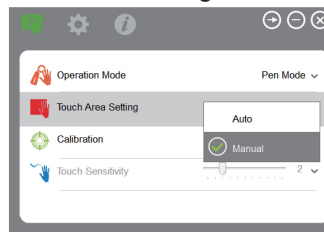

2-1 After the camera captures the projection image, a Touch Area window will pop up. If the captured image is not clear enough, please re-select "Ambient light mode selection" from "Auto" to "Bright" or "Dim" according to actual ambient light condition. Then press "Preview" and the camera will re-capture the image.



2-2 Touch Area Boundary Fine-tuning

- Step 1: Click on P1, use mouse to drag P1 to upper left corner. Align adjustable green zone with projected white frame.
- Step 2: Adjust P2 to P4 accordingly, adjustable green zone should completely overlap with projected white frame.
- Step 3: Finally, check again if all the green frame overlap completely with projected white frame. If not, fine-adjust again.

2-3 When the Touch Area is correctly located, click to "Exit."

Calibration

1. Select Auto Calibration

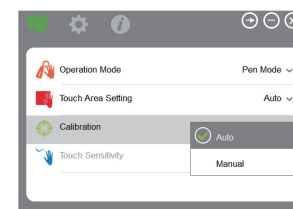

Note:

- If the fail message pops up, follow below steps to trouble-shoot and do Auto Calibration again.
 - Close all software application
 - Reduce ambient light
 - Do not obstruct or shake lens during calibration
 - Check if projection image is clear. If not, adjust focus to sharpen the image
- If the Auto Calibration fail message still pops up on screen, switch to Manual Calibration.

2. Select Manual Calibration

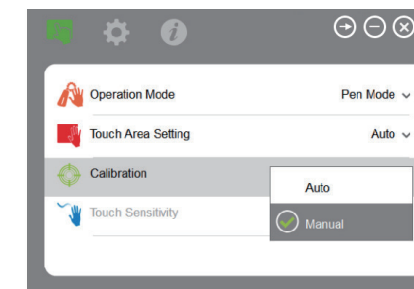

Note: Manual Calibration is suggested for better accuracy.

Trouble-shooting Viewer

Sometimes infrared red light (IR light) from ambient light may interfere with touch performance. Trouble-shooting Viewer shows real time image for debug purpose. Switch between Visible Light/IR Light to remove interference on whiteboard/from ambient observed via Trouble-shooting Viewer.

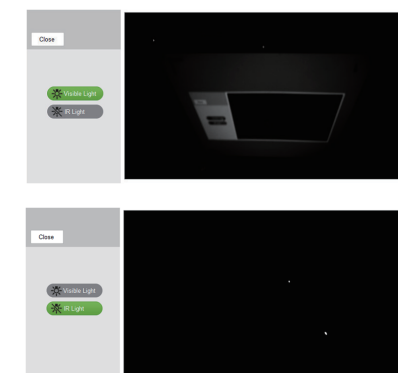

Note: Touch function is disabled under Trouble-shooting Viewer.

LightPen Installation-Windows

● LightPen-Dual Installation

- Step 1. Insert the "Owner's Manual" CD-ROM into the CD drive.
- Step 2. Open the "LightPen Software for Windows" folder in the CD-ROM.
- Step 3. Double click " Setup.exe" by mouse.And then the window will appear as below
- Step 4. Click" LightPen-Dual" .And then "Setup Wizard" window will appear as below.Click "Next" to install.

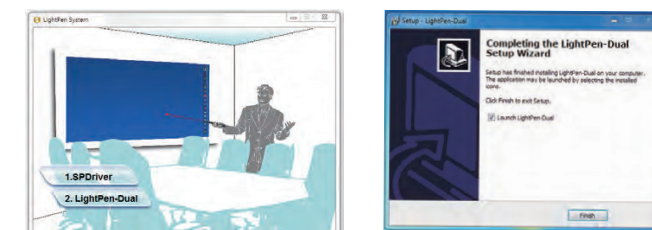











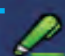

LightPen Installation-Mac

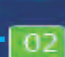
● LightPen3 Installation

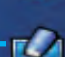
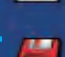
- Step 1. Insert the "Owner's Manual" CD-ROM into the CD drive.
- Step 2. Open the "LightPen Software for Mac" folder in the CD-ROM and copy"LightPen3.zip" to the disk.
- Step 3. Double click and move LightPen3 ICON to computer screen and execute it.

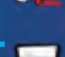
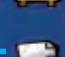
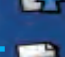
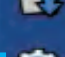
Function of Each Icon in The Tool Bar

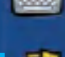
- Mouse**  To change function to Computer Mouse
- Red pen**  To change function to red pen
- Green pen**  To change function to green pen
- Blue pen**  To change function to blue pen
- Marker pen**  To change function to marker pen
- Drawing tool**  To draw a circle, a square, a triangle or a straight line
- Fineness and color of pen**  To select the fineness and color of pen
- Eraser**  To erase drawing
- Clean all**  To erase drawing on the screen all at once
- Save file**  To save the current page into file in computer
- Dual Pen**  To support two pens writing at the same time
- White Board**  To change function to white board
- Page up**  Previous page
- Page down**  Next page
- Edit tool**  To edit drawing
- Keyboard**  On screen keyboard
- Exit**  To exit the application

Advanced Function in Tool Bar

a : Drawing Tool

Select,  then Drawing Tool function menu will be shown on the screen as below. Please select the icon you want to use

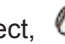

b : Dual Pen

Select,  then Dual Pen function menu will be shown on the screen as below. Please select the icon you want to use

◎ Full Screen Mode

Use two pens at the same time on full screen by same setting.

◎ Split Screen Mode

Use two pens at the same time on two split screen by different setting.

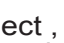

c : Whiteboard Mode

Select,  screen will change to white color background.

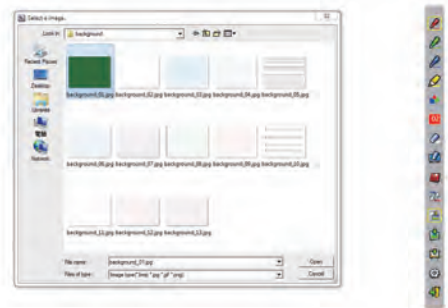

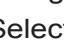

◎ Select,  you can see the below interface. You can select any picture you want to be used on background.

◎ Select,  background will turn to White board mode. If you want to exit White board mode, just click again.

※ If you want to exit White board mode, just click  again.

d : Edit Tool

Select  edit tool bar is shown as blow.

Select drawing line as an object.  An object can enlarge, decrease, or move

Rotate the drawing object you choice 

Print the current page you are seeing 

Undo the last operation 

Redo the last operation 

Spotlight function. 

Curtain function. 

Change the vertical toolbar to a horizontal toolbar. 

Switch the toolbar position to the right/left side. 



PowerPointer® Tool

This function can be executed by LightPen-Dual and LightPen3.

The PowerPoint® Tool does not support Microsoft Office PowerPoint® 2002.

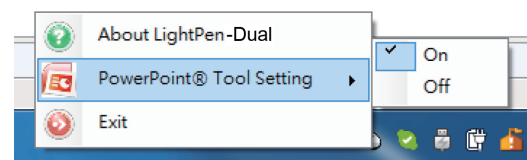

If you click mouse icon on the task bar and select "PowerPoint® Tool setting" as "ON", when you use PowerPoint® and show your PowerPoint® file as "Presentation mode", PowerPoint® tool will be shown in the right side of screen.

LightPen Introduction

By John

When you exit "Presentation mode", PowerPoint® tool will be closed automatically.

a : Function of each icon in PowerPoint® Tool bar

Make toolbar as a small icon. 

Change PowerPoint® Toolbar to another side 

Change function to Computer Mouse. 

Change function to Computer Mouse Right Key. 

Change function to red pen. 

Erase drawing. 

Erase drawing on the screen all at once. 

Go to last page. 

Go to next page. 

Select page. 

Exit Presentation Mode. 



Troubleshooting

Q1: Why cannot the PC boot when the USB cable which connects PC and projector is already plugged in?

A: 1. Unplug USB cable from PC; or
2. Go to BIOS setup page of PC and modify the "Boot priority order." Choose Hard disk as top priority, save the change and reboot PC.

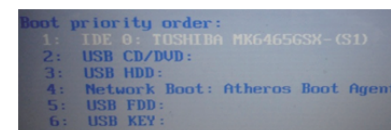

Q2: Why utility icon () is red, not green ()?

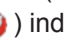
A: Red icon () indicates a failed connection. This may be caused by following:

(1) Check if interactive function is enabled via OSD selection.

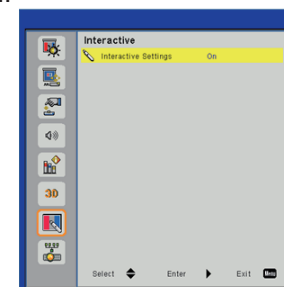

- (2) Unplug/re-plug in the USB cable and check again.
- (3) Switch to another USB port and check again.
- (4) Restart your computer and check again.
- (5) Go to Power Options in Control Panel; check USB selective suspend settings status in USB settings under Advance Settings. Switch to "Disabled".

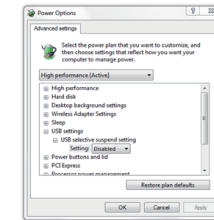
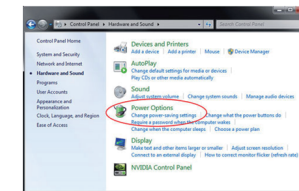

Q5: What to do when Auto Calibration and Auto Touch Area Setting both failed?

A: 1. Check "Ceiling Mount" OSD setting first. The interactive function supports Ceiling Mode only

When projector OSD message is shown, this may result failure to Auto Calibration and Auto Touch Area Setting. Please wait until OSD message is gone before performing Auto Calibration and Auto Touch Area Setting.

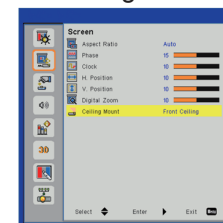

Please follow below trouble-shooting steps to perform Auto Calibration and Auto Touch Area Setting again.

- a. Quit all software application
- b. Reduce ambient light
- c. Do not obstruct or shake lens during Calibration
- d. Check if projection image is clear. If not, adjust focus to sharpen the image.
- e. If the "Auto Touch Area Setting failed" or "Auto Calibration failed" message pops up on screen again, please switch to Manual Mode to do Touch Area Setting and Calibration.

Q4: Why I cannot execute calibration on the circle target mark?

A: (1) Please check if "Pointer" or "Light Pen" works:

- (1-1) Please check if "Pointer" or "Pen" battery is low or battery cap is loose.
- (1-2) When using "Pointer" or "LightPen", be sure to locate the tip of the "Pointer" or "LightPen" in the site of the CMOS sensor in front of the projector. If the sensor cannot see it, the Interactive system does not work.

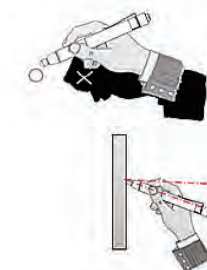

The writing should be avoided in the shadows.

Using Light pen to maintain 25° or above with projection screen.

(2) The ambient light may be too strong. Take the light out of the site of the CMOS sensor. Strong ambient light is usually caused by the following:

- (2-1) Sunlight through the windows near the screen.
- (2-2) Light source working close to the sensor or the screen

